

Phothera 200



Phothera 200

The Phothera 200 is a lightweight, powerful, and easily portable panel phototherapy device.

Phothera

Phothera 200

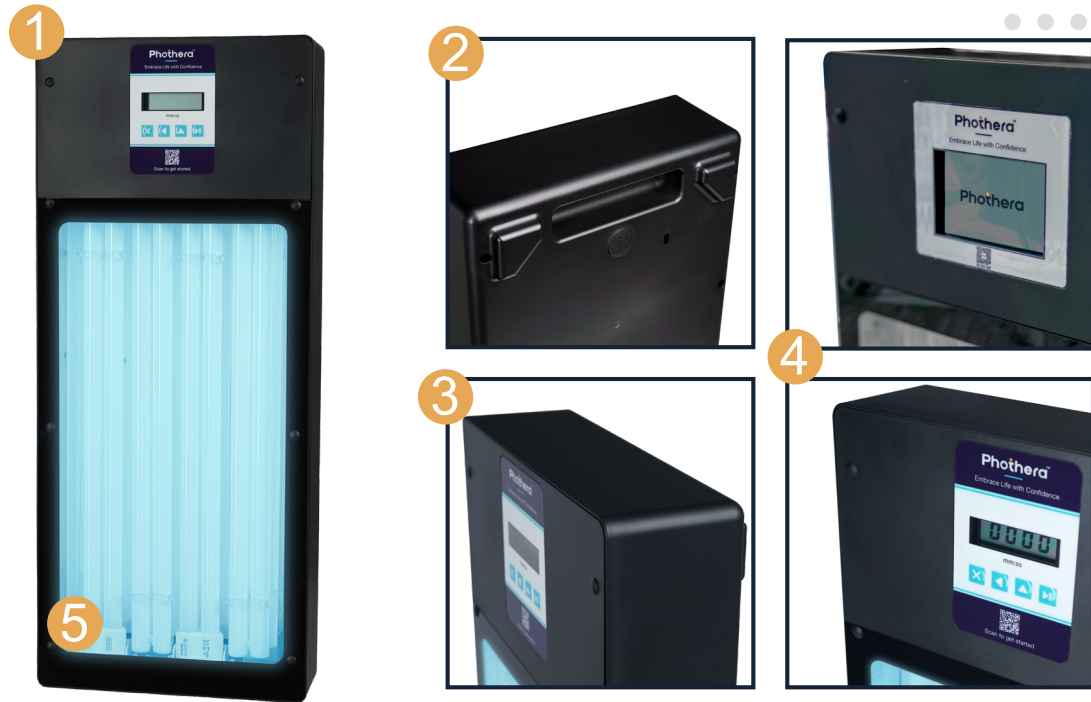

- 1 The Phothera 200 offers choice when choosing lamp quantities and wavelengths:
 - 4 high output, PL-L lamps
 - Narrowband UVB, UVA, or UVA-1
- 2 The Phothera 200 case features a sleek, lightweight, and ergonomic design that offers both practicality and functionality to the user.
- 3 The slim design of the Phothera 200 makes it ideal for travel or can easily be stored when not in use.
- 4 The Phothera 200 offers both simplicity and flexibility, with two customizable controller options designed to fit each patient's unique needs and goals.
 - ClearLink Controller - Safety, security, and patient monitoring, all in an intuitive, touch-screen controller.
 - DT Controller - Simplicity in the form of a time-only controller.
- 5 A special UV transmitting shield covers and protects the lamps while also providing a comfortable resting place for the hands and feet during treatment.

Treatment Area	9.25" x 18"	23.5 cm x 45.7 cm
Width	9.5"	24.1 cm
Height	22.5"	57.1 cm
Depth (including feet)	3.5"	8.89 cm
Weight	7 lbs	3.1 kg

For further information, please contact Phothera:
216.831.0600
phothera.com | info@phothera.com